

Callide Valley Flood Review Update

AUGUST 2015

Welcome to the second edition of the Callide Valley Flood Review Update.

In June 2015, the Inspector-General Emergency Management, Iain MacKenzie, completed an independent review into the February 2015 Callide Creek flood event and made thirteen recommendations. The recommendations were listed in the July edition of this newsletter and the detailed report can be downloaded from www.igem.qld.gov.au/callide/.

The recommendations are being actioned by Banana Shire Council (BSC), the Council's Local Disaster Management Group (LDMG), SunWater, the Department of Energy and Water Supply (DEWS), the Department of Natural Resources and Mines (DNRM), the Bureau of Meteorology (BOM) and the State Disaster Coordination Centre (SDCC).

This update has been prepared by the agencies to inform the Callide Valley community on how activities are progressing to address the recommendations.

A further update will be provided in late September.



Improving Warning Systems

(Recommendations 7, 8 & 9)

BSC and SunWater held a strategy workshop in early August to commence development of a multi-channel warning strategy for the Callide Valley area. The group discussed a range of communications methods to ensure all community members that are likely to be affected by future events are given timely information and warnings. This workshop also reviewed areas of responsibility around notifications to the community. Further details regarding the proposed warning strategy will be included in the September edition of this newsletter.

SunWater has recently written to residents in the directly affected downstream zone of Callide and Kroombit Dams and the Moura Offstream Storage encouraging them to register their contact details with SunWater so that they can receive direct warnings in outflow events. Please refer to the Notice of Opportunity included in this newsletter which has also featured in the Central Telegraph on 21 August 2015.

SunWater is arranging modelling of dam outflows in the areas immediately downstream of Callide and Kroombit Dams and will prepare maps of the extent of local flooding for different outflows. This will further assist in the identification of local residential properties directly affected by specific dam outflows and may be used to confirm or adjust this zone in the future.



Developing Community Awareness and Education Strategies

(Recommendations 3 & 4)

BSC is developing a public information campaign to create awareness in the community about general disaster management arrangements and warnings. This campaign will also focus on risks such as bushfires, cyclones, flooding from various sources in the Callide Valley and district, as well as earthquakes.

Information about the operation of the two dams as well as the potential impacts of various dam outflows will be made publically available on SunWater's website and social media. In addition, residents in the directly affected downstream zone will be provided with this information and other ongoing communications relating to the operation of the dams via mail and SMS alerts.



Reviewing Disaster Management Coordination Arrangements

(Recommendations 5, 10, 11, 12 & 13)

BSC recognises that the most important resource during any disaster event is the people operating the Local Disaster Co-ordination Centre. BSC commends all personnel on their outstanding efforts during the Tropical Cyclone Marcia event, however recognises there are still opportunities for improvements. During emergency events fatigue and a lack of resources can cause issues, therefore BSC has undertaken a full review of staffing arrangements for the Local Disaster Co-ordination Centre to better utilise the very valuable human resources available.

Additionally, the BSC is currently completing its Business Continuity Plan to cover all of Council business. Part of this plan will identify alternative sites for the Local Disaster Co-ordination Centre if the existing site at Council's Administration Complex in Biloela is unable to be used.

The LDMG's sub-committee on the Evacuation Plan has met and will be making recommendations to the LDMG. BSC has also developed trigger points to help encourage self-evacuation and these will form part of the public information campaign.

In response to Recommendation 5, DEWS have held discussions with SunWater to examine the opportunities and implications of adopting more flexible approaches with respect to Emergency Action Plans. These discussions are ongoing and are focussing on how to respond appropriately to emergency situations that are not specifically contemplated by an Emergency Action Plan whilst ensuring compliance with the provisions of the *Water Supply Safety and Reliability Act 2008*.



Reviewing the Flood Gauging Network

(Recommendation 6)

In late July, BSC met with BOM and SunWater to discuss a suitable gauge network for flood warnings in the Callide Valley. The meeting explored the intent and requirements for achieving "meaningful" and "timely" flood warnings. Consideration was given to whether the current observation network and technology was adequate, what is at risk in terms of people, property and infrastructure, as well as if an expansion of the current network would provide additional benefit. Outcomes of these initial discussions have been provided to the DNRM and the Inspector-General Emergency Management.



Commissioning Detailed Flood Studies

(Recommendations 1 & 2)

Work is well underway by the BSC's consultants to complete catchment-wide mapping and flood studies for the Banana Shire. The consultants have indicated that the first stage of modelling, which will identify areas that are likely to be affected by flooding from various sources, will be completed in September 2015. BSC is still waiting for funding to be approved by the Department of Infrastructure, Local Government and Planning to complete the second stage of the study which will consider mitigation strategies.

Work is also underway by DEWS and SunWater to assess the available information and establish terms of reference for consultants to analyse the potential flood mitigation outcomes, costs and benefits associated with operating Callide Dam differently for a range of different size flood events. Alternative means of effecting improved community outcomes will also be considered.

Modelling has also commenced to assess the potential impacts on the reliability of water supply to irrigators, industries and towns dependent on the dam.

The expected completion date for the feasibility studies relating to operating Callide Dam as a flood mitigation dam remains as mid-2016.

NOTICE OF OPPORTUNITY: INCLUSION ON THE SUNWATER EMERGENCY ACTION PLAN NOTIFICATION LIST

Local residents living downstream of Callide Dam, Kroombit Dam or the Moura Offstream Storage, who have not previously registered, have the opportunity to register and be included on the SunWater Emergency Action Plan Notification List.

SunWater is writing to residents located within the red area indicated in the maps below to invite them to provide details of their contact name, address, lot on plan number, phone, mobile and email address. If you are located within the marked area below and do not receive a letter, please contact SunWater on the details below if you would like to be included on the notification list.

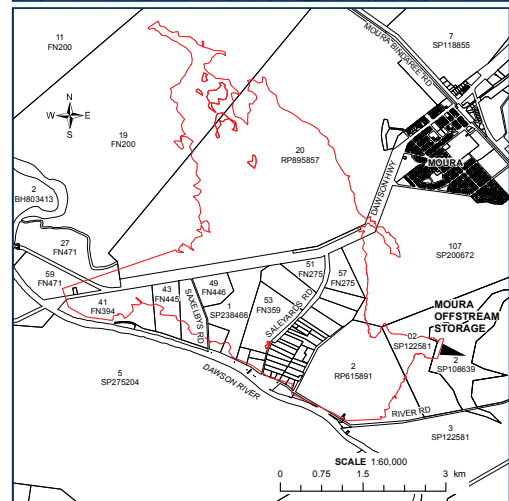
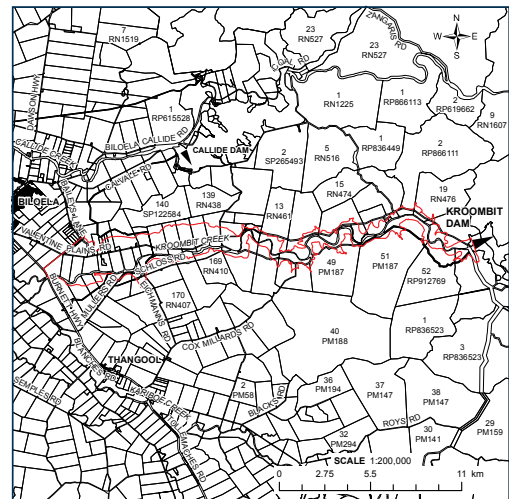
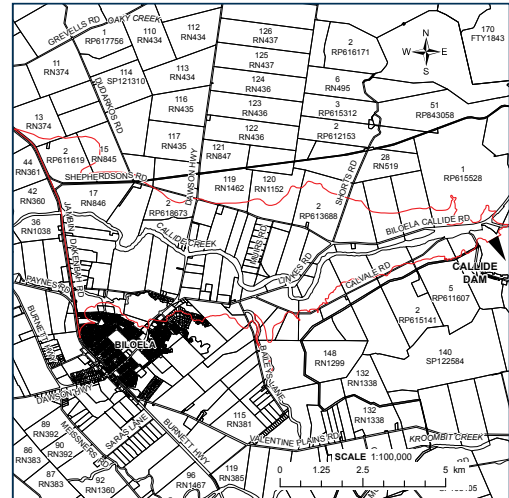

Once registered and the assessment of validity is completed by SunWater staff, local residents will be notified of dam flood releases and emergency information by SMS.

Local residents wishing to register should call **13 15 89** before 28 August 2015.



For more information, please contact:

Banana Shire Council's Infrastructure Services Department on (07) 4992 9500
SunWater on 13 15 89

Copies of this Update may be a downloaded from www.banana.qld.gov.au or www.sunwater.com.au

